



**F6 Extra**  
**R6 SKG**  
**R11 Progress**  
**R50 CS1**



**F6 Extra S**  
**R7 Extra**  
**R50 Extra**



TS007:2014  
 One Star Rated Cylinder  
 KM544418

This product **MUST** be used in conjunction with two star security door furniture meeting TS 007 to ensure security.

**F6 Extra - F6 Extra S**  
**R7 Extra - R11**  
**R11 Progress - R50**

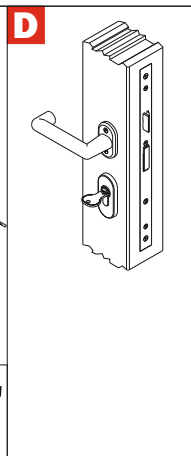
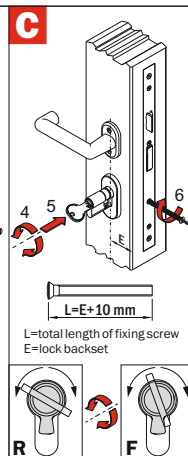
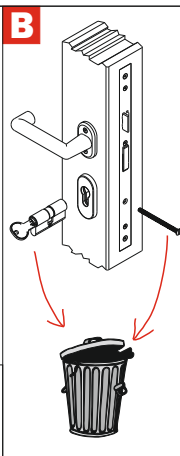
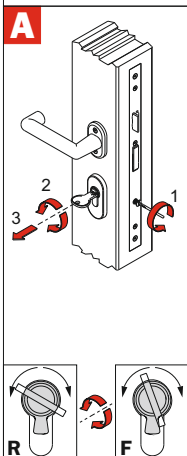
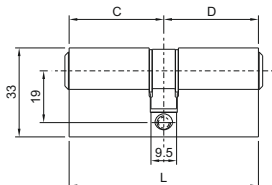
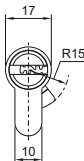
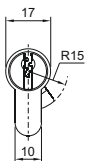

## Montage voorschrift

ISEO producten zijn onderworpen aan nauwkeurige kwaliteit controles gedurende de productie volgens vastgestelde procedures van UNI EN ISO 9001.

De ISEO SKG® cilinder voldoet aan de SKG® normen en is voorzien van het kwaliteit merk "Politie Keurmerk Veilig Wonen®".

Deze cilinder kan gecombineerd worden met SKG® goedgekeurde sloten en accessoires.

De SKG® norm van de cilinder moet gelijk zijn aan de SKG® norm van de andere gemonteerde artikelen.

De ISEO SKG® cilinder heeft aan beide zijden boorbeveiliging.

De cilinder mag niet meer dan 3 mm uitsteken aan de buitenzijde van de deur of deurbeslag.

Dit product nooit smeren met olie maar met een smeermiddel speciaal voor cilinders (type Rivolta TRS Plus of gelijkwaardige).

## Fitting instructions

ISEO products are subjected to scrupulous quality controls throughout the production cycle according to the procedures established by the UNI EN ISO 9001 standard.

The ISEO SKG® cylinder meets the SKG® quality requirements and complies with the quality mark of the Dutch Police "Veilig Wonen®".

This cylinder can be combined with SKG® approved locks and safety accessories.

The SKG® class of the cylinder must be equivalent to the SKG® class of the products combined with it.

The ISEO SKG® cylinder has extra drilling protection on both key sides.

The cylinder shall not protrude by more than 3 mm from the outside of the door or from any protection plate.

Lubricate exclusively with teflon lubricant type: Rivolta TRS Plus or equivalent.

This cylinder offers resistance to many types of attack. It is designed to be used in conjunction with two star security door hardware to ensure enhanced resistance to all commonly used attack methods. Therefore this product MUST be used in conjunction with two star security door hardware meeting TS 007 to ensure security.

Such hardware can be recognised by the two star marking which may either be visible from the outside on an installed handle or, failing this, will be visible once the outside handle has been removed.

Security hardware can be of several types, including a handle with a reinforced backplate, an escutcheon or a device which is concealed behind the handle backplate. In all cases, the purpose is to protect your cylinder from force attack."

## Instructions de montage

Les produits ISEO sont soumis à un strict contrôle de qualité pendant tout le cycle de production, conformément aux dispositions de la Norme UNI EN ISO 9001.

Le cylindre ISEO SKG® satisfait aux conditions de qualité SKG® et est conforme à la marque de qualité de la Police Hollandaise "Veilig Wonen®".

Ce cylindre peut être associé à des serrures et des accessoires de sécurité approuvés par SKG®.

La classe SKG® du cylindre doit correspondre à la classe SKG® des produits associés à celui-ci.

Le cylindre ISEO SKG® présente des protections supplémentaires anti-perceuse sur les deux côtés de la clé.

La saillie du cylindre ne doit pas dépasser les 3 mm de l'extérieur de la porte ou de la plaque de protection éventuelle.

Lubrifier en utilisant exclusivement un lubrifiant au téflon du type: Rivolta TRS Plus ou équivalent.

## Montage-Anweisungen

Die ISEO-Produkte werden während des gesamten Produktionszyklus einer sorgfältigen Qualitätskontrolle entsprechend der Vorschrift UNI EN ISO 9001 unterzogen.

Der Zylinder ISEO SKG® entspricht den SKG®-Qualitätsanforderungen und dem Qualitätszeichen der holländischen Polizei "Veilig Wonen®".

Dieser Zylinder kann mit Schlössern und Sicherheitszubehörteilen verwendet werden, die von SKG® zugelassen worden sind.

Die SKG®-Klasse des Zylinders muss dieselbe wie die SKG®-Klasse der in Verbindung mit dem Zylinder verwendeten Produkte sein.

Auf beiden Seiten des Schlüssels ist der Zylinder ISEO SKG® mit zusätzlichen Schutzelementen gegen Bohrungen versehen.

Der Zylinder darf nicht mehr als 3 mm über die externe Seite der Tür bzw. die Schutzplatte hinausragen.

Zur Schmierung ist ausschließlich ein Teflon-Schmiermittel des Typs Rivolta TRS Plus oder gleichwertige.

## Istruzioni di montaggio

I prodotti ISEO sono sottoposti ad uno scrupoloso controllo di qualità in tutto il ciclo produttivo secondo le procedure previste dalla Norma UNI EN ISO 9001.

Il cilindro ISEO SKG® soddisfa i requisiti di qualità SKG® ed è conforme al marchio di qualità della Polizia Olandese "Veilig Wonen®".

Questo cilindro può essere abbinato a serrature ed accessori di sicurezza approvati dalla SKG®.

La classe SKG® del cilindro deve essere equivalente alla classe SKG® dei prodotti ad esso abbinati.

Il cilindro ISEOSKG® ha delle protezioni supplementari antitrapano da entrambi i lati chiave.

Il cilindro non deve sporgere più di 3 mm dall'esterno della porta o dall'eventuale placca di protezione.

Per lubrificare usare esclusivamente lubrificante al teflon tipo: Rivolta TRS Plus o equivalente.